

TRADITIONAL WHALE

<http://library.thinkquest.org/27152/towns/oriville/oriver/practice/04.htm>

The recommended size of a paper 20 x 20 cm

- 1 Valley fold a sheet on diagonals.
- 2 Valley fold the model half-and-half.
- 3 Valley fold the top lateral sides, combining them with a diagonal.
- 4 Mountain fold top back, by combining it with the bottom corner. The line of a bend should pass through the specified points.
- 5 Open and pull corners upwards, simultaneously 'valley' folding the lateral sloping edges to meet the vertical middle line.
- 6 Valley fold a corner of the top layer up to border inside model.
- 7 Valley fold a corner down to meet the bottom of the top layer.
- 8 Valley fold upwards one layer.
- 9, 10 Valley fold model half-and-half from the left to the right and turn it counter-clockwise.
- 11 By opening layers, fold inside corner... A tail also will turn out!
- 12 Valley fold a part of the fins to a tail.
- 13 Open a mouth to a whale and record it, by compressing with sides.
- 14 Insert a fountain between layers and glue it. The whale is ready to sail!

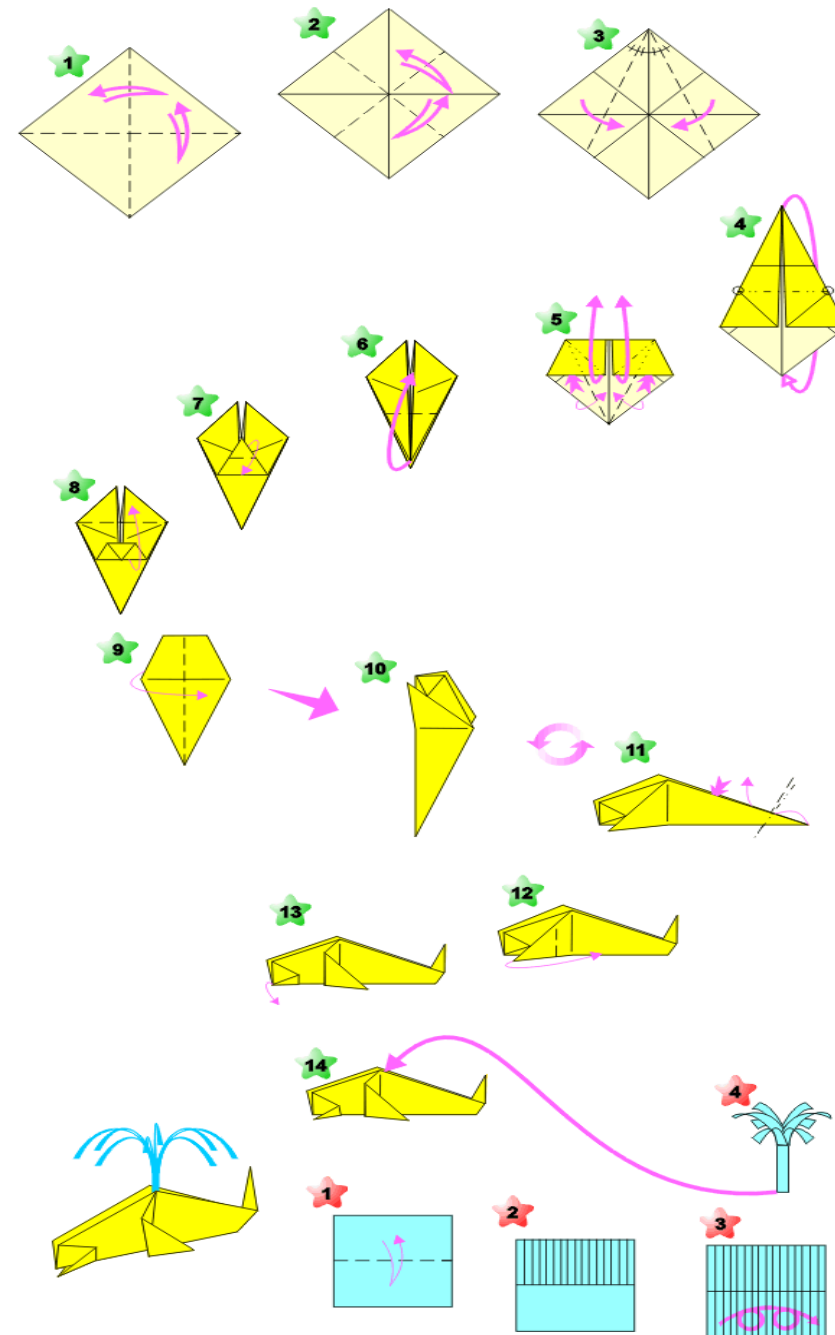

FOUNTAIN initial squares in a technique of Kirikomi-Origami

- 1 Valley fold a sheet half-and-half. Unfold it.
- 2 Make some cuts in the top of a square.
- 3 Twirl a sheet as shown.

The whale is ready to sailing!

Origami Whale from http://www.hardin.k12.ky.us/japan/orig_whale.htm

1. Place origami paper color side down so that one of the points is at the bottom.

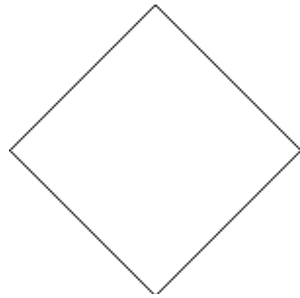

2. Fold origami paper in half, from left to right, making a taco fold. Crease well. Unfold.

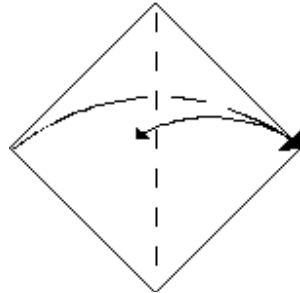

3. Fold the lower left and right sides to meet at the center crease you made in step 2. Crease well. Your origami should look like a kite.

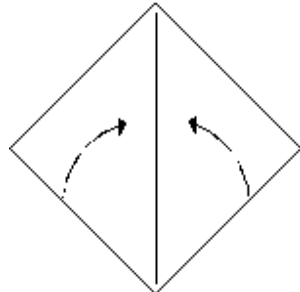

4. Now fold the top point of the origami down to meet the top edges of the sides you folded in in step 3 to make a small triangle.

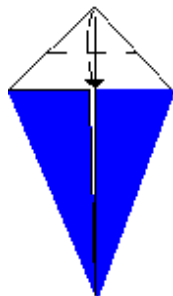

5. Fold the left side of the origami over to meet the right side. Crease.

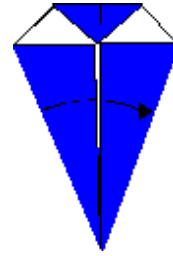

6. Put your finger on the bottom point and turn the whale sideways (clockwise).

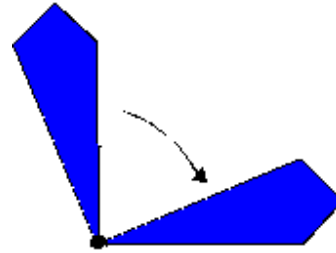

7. Fold the end point up to make a tail. You can tear or cut along the center of the tail to make flukes for your whale.



8. Fold down the top point of the head and draw a happy face...Have a whale of a day!

