

Blubber Glove - Help children discover how dolphins keep warm

Equipment:

- bucket / bowl
- 2 x plastic sandwich bags (or similar)
- block of vegetable fat
- thick sticky tape
- towel
- ice cubes (in thermos flask if necessary)
- dolphin cut-out approx 2.5m long (pattern overleaf)
- dolphin cut-out approx 3.75m long (pattern overleaf)
- tape measure
- map of world sea temperatures with Florida and Scotland marked clearly



www.wdcs.org

WDCS is the global voice for the protection of whales, dolphins and their environment

Registered Charity No: 1014705

Preparation:



1 Line the inside of one plastic bag with slices of vegetable fat.



2 Put the other bag inside this.

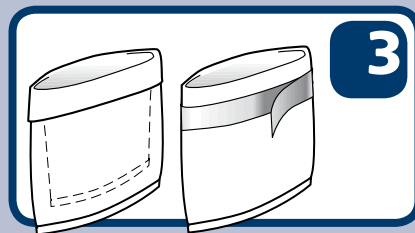

3 Seal the tops of the two bags with strong sticky tape so that fat is contained within.



4 Mould the fat through the plastic so that it becomes a solid layer with no gaps.



5 Write 'Blubber Glove' on the outside in waterproof marker.



6 Part fill the bucket/ bowl with cold water, add the ice cubes. Lay the dolphin cut-outs on the floor.



Dolphin Patterns

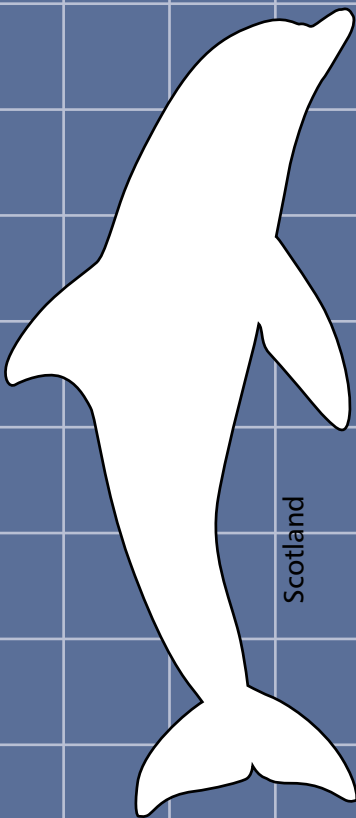
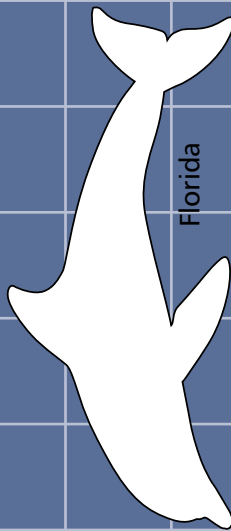

each square = 0.5 metre

Instructions:

- ➔ Get the children to measure the dolphin cut-outs and explain that the small one is the size of an adult bottlenose dolphin in Florida, whilst the large one is the size of an adult bottlenose dolphin in Scotland.
- ➔ Discuss the possible reasons for this using the sea temperatures map as a hint.
- ➔ Explain that dolphins in Scotland have to be much bigger to survive the colder sea temperatures and that they are the largest bottlenose dolphins in the world because they are the most northerly resident population in the world.
- ➔ Explain that blubber is basically fat and so insulates them from the cold.
- ➔ See if blubber actually works:
Get the children to dip their hand in the cold water with no protection (have a towel to hand to dry off).

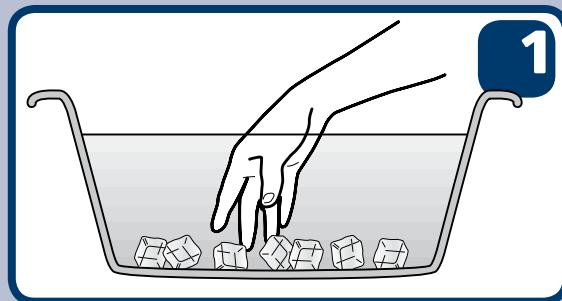

Then the children try it again with the blubber glove on. Ask if they can feel any coldness from the water. They shouldn't be able to!

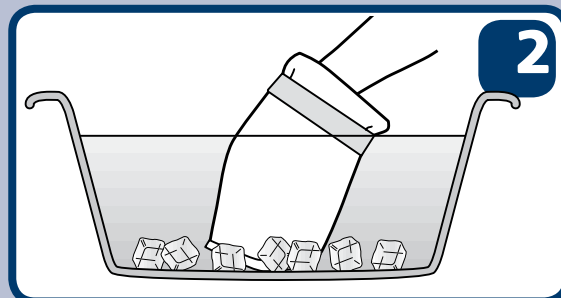

- ➔ Ensure that water doesn't end up inside the blubber glove as this ruins the effect.

Average Summer Sea Temperatures

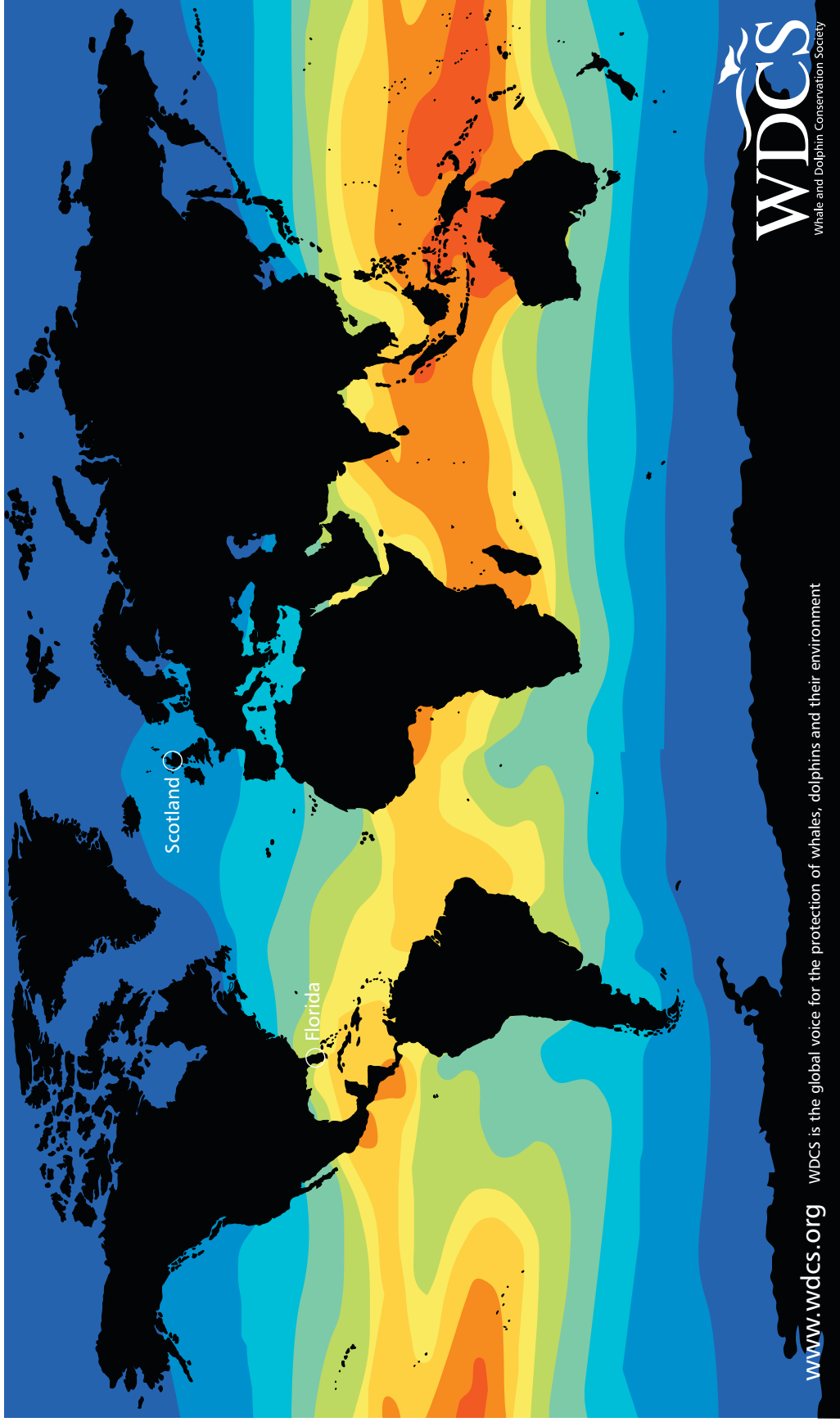

www.wdcs.org WDCS is the global voice for the protection of whales, dolphins and their environment

WDCS
Whale and Dolphin Conservation Society

Registered Charity No. 1014705